

SET UP INSTRUCTIONS FOR 4033F2

Make sure to place your fountain on a firm area which will not settle. Note: Always follow local electrical codes and use a 110V GFCI protected outlet.

1) Set the 4033A Large Basin & Bowl unit on your prepared setting.

2) Reaching into the pump cavity, thread the larger plastic barbed adapter into the horizontal opening. Push tube onto the adapter's barbs. Slip flow restrictor clamp onto the middle of the tube and close enough to hold in place.

3) Place pump in the cavity and thread the smaller barbed adapter into it. Push the open end of the tube onto this adapter's barbs.

4) Set the light inside the basin across from the pump cavity. Aim the light at the space between the two highest spill bowls.

5) Feed both the pump power cord and the light's power cord down through the large hole in the pump cavity. Make sure to leave an extra foot of light power cord in the basin. Then, install the rubber stopper in the large hole by pressing the power cords into place within the stopper and then pushing the stopper down in the hole to make the basin watertight.

6) Four flat copper "spill plates" are provided with this fountain along with some silicone sealant. Squeeze out some silicone onto the concrete spill plate

cut-out edge in the three bowls. Next, place the largest spill plate on the highest bowl and place the other smaller plates on the remaining spill edges in the other bowls. Allow 15 minutes or more for the sealant to begin curing.

7) Fill the bottom bowl with water. Read your pump and light instructions. Then plug in the pump and light. If your pump does not push water right away, there may be an "air-lock" in the pump's impeller chamber. Simply unplug and plug back in several times and the air-lock should clear.

8) Your kit includes shims. This fountain needs to be very level for the top two bowls to be balanced. Once you start the water flow you can assess how level the fountain is. If the water seems to be leaning to the left – push two shims under the left side and vice versa if water leans to the other side. If you feel the fountain pump is producing too much water flow, simply tighten the flow restrictor to reduce the flow.

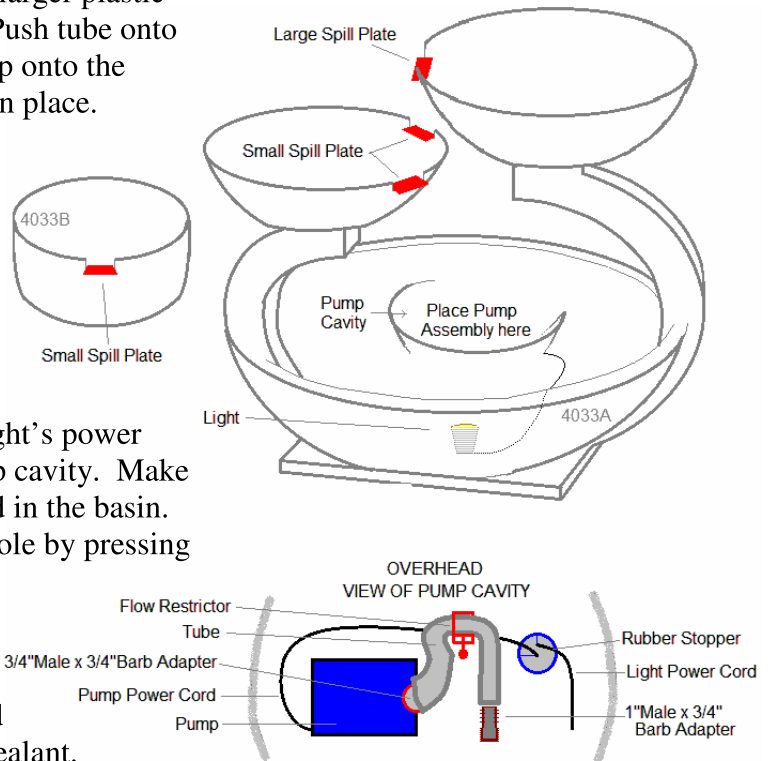

IMPORTANT – WINTER CARE

Winter ice build-up can cause damage to concrete statuary. Follow these tips to reduce winter weathering to your fountain:

- * Disconnect power to pumps and lights.
- * Remove plugs / stoppers in all fountain bowls to open drains and let all moisture out. Keep drains open throughout winter.
- * Place an absorbant material like burlap, blankets, etc. inside vases/bowls and cover all with a Henri fountain cover.
- * Do not allow snow or ice to build up on or against the concrete. Remove snow before it turns to ice. Do not use antifreeze, salt or chemical ice removers as these may damage concrete.

8/25/16