

# SETTING UP THE 5836F

Make sure to place your fountain on a firm and level surface which will not settle. This fountain will look best when placed against a wall or other solid backdrop. Note: Always follow local electrical codes and use a 110V GFCI protected outlet. Do not let children climb on fountain.

- 1) Place the 7837 Bottom Riser on your prepared site, just slightly away from any wall to allow space for the power cord.
- 2) Set the 7836 Pedestal on the Bottom Riser. Align it to the back and edges of the Riser. Level as necessary.
- 3) Place the 6836 Half Bowl on the Pedestal. Caution: this piece is heavy; be sure you have sufficient help before lifting. Level and align as necessary.
- 4) Set the Pump in the reservoir inside the back of the Bowl. Run the power cord out over the back wall through the notch provided. Insert the Barbed Adapter into the top of the Pump. Push the wider water tube over the Barb and clamp it on. Clamp the Tee onto the other end of the tube.
- 5) Push the smaller water tubes onto each of the smaller ends of the Tee. Add the Flow Restrictor to the tube on the right side and tighten it just enough for it to stay in place. (This can be further tightened to adjust the water flow later.) Drape these two tubes over the back wall of the Bowl in preparation for their connection.
- 6) Place the 5836 Top Flatwall on the Bowl. Caution: this piece is also heavy and requires sufficient help. You may find it best to push the tubes onto the pipes of the Flatwall while others are holding the Flatwall above the Bowl. Then, carefully set it down while making sure to not pinch or trap the tubes between the Flatwall and Bowl pieces. Align the Flatwall over the Bowl so the bolt holes shown in the drawing line up.
- 7) Secure the Flatwall to the Bowl by inserting the bolts with brass washers from the top and fastening with the stainless washer and wingnut from underneath. Use silicone sealant (provided) to affix the three copper spill plates to the spill edges near the bottom of the Flatwall. They work best if the front edge of the plate sticks out about 1/4" from the concrete edge.
- 8) Fill the Bowl with water. Read pump instructions. Turn on the pump. If it does not immediately begin working, there may be an "airlock" within the impeller chamber. Simply unplug and plug in a few times and it should start.

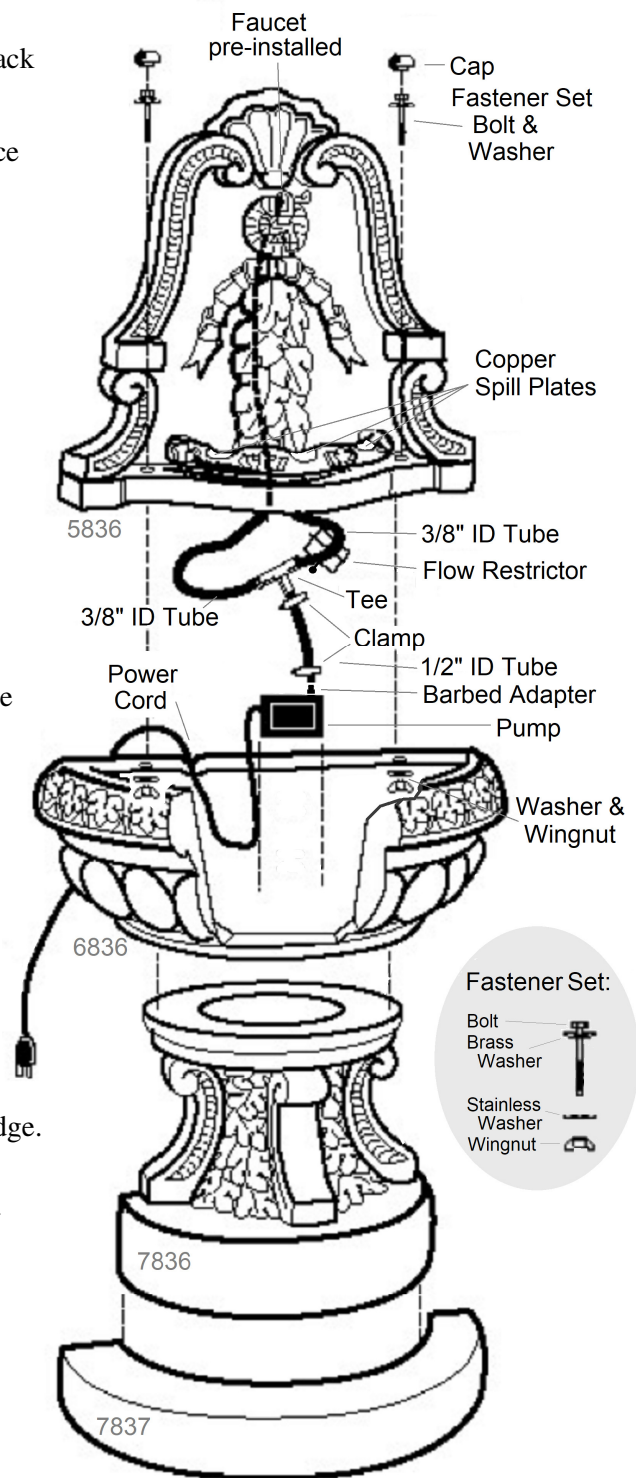

Csd

6/2022

## IMPORTANT – WINTER CARE

Winter ice build-up can cause damage to concrete statuary. Follow these tips to reduce winter weathering to your fountain:

- \* Disconnect power to pump.
- \* Open drain and let all moisture out. Keep drains open all winter.
- \* Cover with a Henri fountain cover. Keep tight and do not let snow or water collect in sagging areas.
- \* Do not allow snow or ice to build up on or against the concrete. Remove snow before it turns to ice. Do not use antifreeze, salt or chemical ice removers as these may damage concrete.

## Online Resources

Products: [www.henristudio.com/products](http://www.henristudio.com/products)  
FAQs: [www.henristudio.com/faq](http://www.henristudio.com/faq)  
Warranty: [www.henristudio.com/warranty](http://www.henristudio.com/warranty)  
Contact : [www.henristudio.com/contact-us](http://www.henristudio.com/contact-us)

Caution: The use of Chlorine or Chlorine Bleach or water coloring additives may damage the finish of your fountain.